

e-slide



| | |
|---------------------------|---|
| STEEL QUALITY | EN 10025-2:2004 - S235JR, cold drawn NBN A 24-302 - BE 500 TS EN 10111:2008 - DD14 |
| MATERIAL THICKNESS | 2 x 5 mm (13/64") upper Slide® waves Body 1,5 mm (1/16") |
| PROFILE LENGTH | 2,60 m (+ 5 mm / - 10 mm) (8.53 ft +13/64" / - 25/64") |
| JOINT OPENNING | Optimal and recommended up to 15 mm (19/32"), load transfer possible up to 25 mm (1") |
| ANCHORAGE | Patented, specially 3D formed rebar \varnothing 6 mm (15/64") as continuous anchorage |
| VERSIONS | Natural steel / Galvanized / Stainless steel AISI 304 or AISI 316 |
| PALLET SIZE | Length 2,60 m (8.53 ft), Width 1,15 m (3.77 ft), height see table |

| Height a [mm] (inch) | Slab thickness [mm] (inch) | b [mm] (inch) | Weight [kg/m] (lbs/ft) | Weight [kg/pc.] (lbs/pc.) | Quantity [pcs./pal.] | Quantity [m/pal.] (ft/pal.) | Gross weight per pal. [kg] (lbs) | Pallet Height [m] (ft) |
|----------------------------|----------------------------------|---------------------|------------------------------|---------------------------------|-------------------------|-----------------------------------|--|------------------------------|
| 130 (5 1/8) | 140 - 150 (5 33/64 - 5 29/32) | 30 (1 3/16) | 8,20 (5.58) | 21,32 (47.00) | 56 | 145,6 (477.69) | 1285 (2844) | 1,15 (3.77) |
| 155 (6 7/64) | 160 - 180 (6 19/64 - 7 3/32) | 65 (2 9/16) | 8,61 (5.79) | 22,39 (49.36) | 49 | 127,4 (417.98) | 1150 (2535) | 1,26 (4.13) |
| 180 (7 3/32) | 190 - 200 (7 31/64 - 7 7/8) | 90 (3 35/64) | 8,91 (5.99) | 23,16 (51.06) | 42 | 109,2 (358.27) | 1025 (2260) | 1,20 (3.94) |
| 205 (8 1/16) | 210 - 230 (8 1/4 - 9 1/16) | 115 (4 17/32) | 9,25 (6.22) | 24,06 (53.04) | 35 | 91,0 (298.56) | 920 (2030) | 1,10 (3.61) |

The e-slide joint is recommended for the use in light and medium loaded floors and for floor thickness' between 140 and 200 mm (5.5" - 8"). Other heights for floor thicknesses above 200 mm (8") are available on request and function of the corresponding design check.

ATTENTION: The load transfer capacity of e-slide® is reduced when compared to Cosinus Slide® but is still considerably greater than discontinued plate- or doweled joints. For calculations, validations and optimal use of the joints for your respective projects, please contact your local dealer or send a request to info@hcjoints.be.

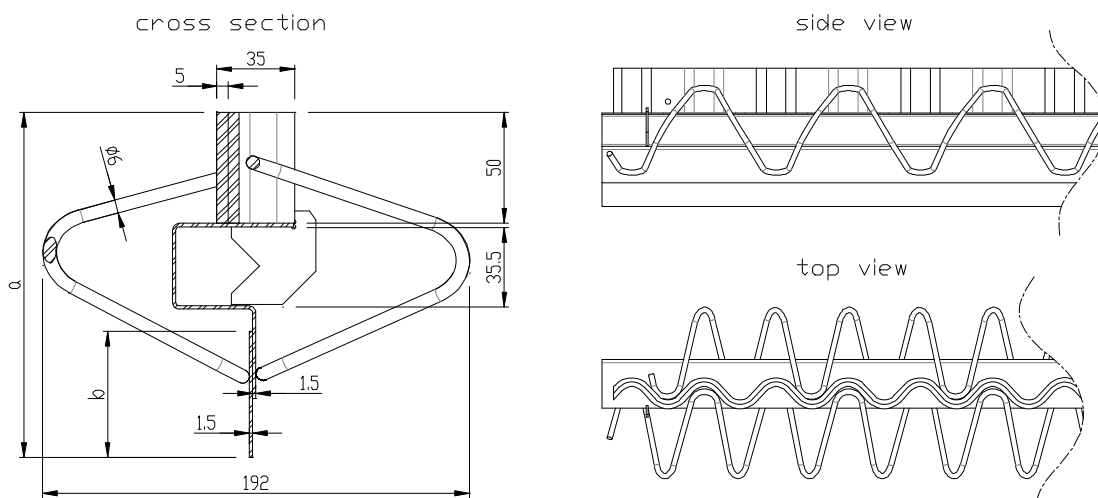

Document issued August 2021. Hengelhoef Concrete Joints nv. reserves the right to alter the products without notice.
©COPYRIGHT 2021 by Hengelhoef Concrete Joints nv.



HENGELHOEF
CONCRETE JOINTS

Hengelhoefstraat 158, Poort Genk 0420, B-3600 Genk
T. +32 (0)89 32 39 80 · F. +32 (0)89 32 39 88
E. info@hcjoints.be

www.hcjoints.be